

Detroit Types/All Together Again Speculation Over Detroit's Existing Landscape

RICARDO SANZ

Universidad Central de Venezuela

SUSTAINABLE AGRICULTURAL COMMUNITY HOUSING

// TEN PROPOSALS

TOWARDS THE COLONIZATION OF THE URBAN LANDSCAPE

This is an experimental academic experience based on Detroit that starts from an urban context on the verge of depopulation and, through the creation of a new partially sustainable community, promotes exploration of the architectonic program over diverse extents on the ways of inhabiting and their relation with productive activities that differ from traditional forms of social organization. This abandoned city is the starting point for a work that explores the possibility of refounding the urban territory on a speculative ground, from the study of preexisting models of alternative social organization that are found on a thin frontier in between an urban apocalypse, and the study of diverse ways of understanding the social contract. To achieve this, the experience proposes the refounding of the city's peripheries through enclaves of families or communes over a mostly inhabited urban space that once was one of America's most industrialized town centers.

HOW WERE IMPLEMENTED THOSE THEMES ON THE EXPERIENCE?

1. Through the gathering of information about the Detroit phenomenon in order to open a series of discussions about Detroit's current situation and the exercise's aims.
1. A series of short exercises allowed to elaborate initial schemes that lead to the social organization system and opened way to the initial idea of the communes
1. Studies on diverse social systems over types and time that could be referenced on the planning proposals.
1. Other references that could nourish the architectonic solution, like standardized constructive systems on wood and their technical specifications in the USA, the use of clean energies and urban architecture as a possibility.

Students: Maria A. Aguiar, Seham Arvelo, Javier Barrios, Mónica Braña, Maria Mercedes Gasiba, Ivan Guzmán, Julio Kowalenko, Julio Mesa, Corina Montero, Manuel Mora, Paola Murcia, Andrea Pérez, Augusto Rivera, Daniel Rodríguez, Jorge Suarez, Adriana Tenorio, Daniel Vidigal, Salvatore Villá, Universidad Central de Venezuela, FAU/EACRV/UD9.

DETROIT TYPES

(ALL TOGETHER AGAIN)

SPECULATIONS OVER DETROIT PRE-EXISTENT LANDSCAPE.
SUSTAINABLE AGRICULTURAL COMMUNITY HOUSING // TEN PROPOSALS

This poster explores the objectives and development of an undergraduate project workshop of speculative nature, based in the possible re-founding of abandoned areas in the peripheries of Detroit (Michigan), from architectural proposals that show and promote systems of communitarian social organization. We focus on four fundamental aspects: the context as crisis, the critical revision of traditional ways of inhabiting, the architectural schemes that support them, and the place as constructive culture. The contents have been instrumented by means of analysis and study of some initiatives that are currently being developed in Detroit, such as ecological agriculture in abandoned urban soil; the relevance of theories and typologies that allow to articulate relations of communal nature, and the understanding of wood constructive systems. These complexes have been designed to house from 1000 to 1500 inhabitants.

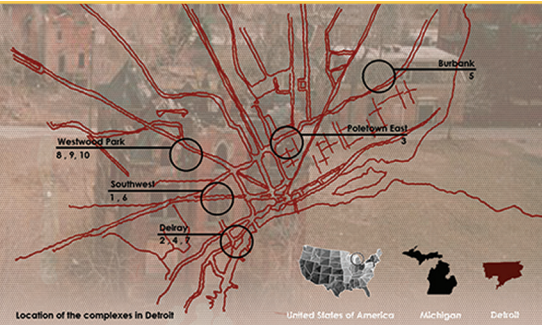

Location of the complexes in Detroit

United States of America Michigan Detroit



Artificial crater
Since its discovery there has been an element in which societies have gathered for a kind of identification and teaching. This project requires the idea of a structure that further in time gives form to a pre-urbanized establishment and consolidates a city nucleus. The project consists of a semi-circular urban form that is transformed into a full-size urban intervention in a detailed and undefined area of Detroit's metropolitan region. The circular urban form developed in the west area of Southwest Detroit. Our main interest in this project is the way it comes from its localized urban state.



Location of the project (Detroit) Southwest



Big Tepees
This project is a symbol between city and countryside, whose main objective is to use the unoccupied space and agricultural production. Thinking of an architecture in abstract form and structure, generated on a reference and very industrial landscape. A kind of organic environment. The cell, is the unit that contains the basic housing form, a way of community interaction with some factors reference the shabby, a construction with character of community dwelling, of pre-urbanized South America.



Location of the project (Detroit) Poletown East

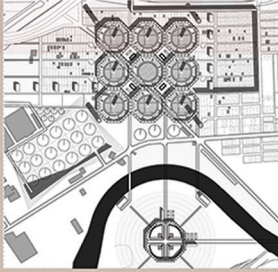

Detroit Renaissance
This proposal aims to be a partially reproduced throughout different areas of Detroit urban landscape. The main objective is to create a community of urban spaces, in order to allow a progressive development of communities. The community must consist of three levels of production, and must be well defined and autonomous, servicing all the required spaces for labor, education, parks, shops and sources of food and energy. The spatial organization is based on the study of the geometric fabric, a paradigm to the original urban plan, together with contemporary city models in the proposal that will allow possible alternatives.



Location of the project (Detroit) Delay

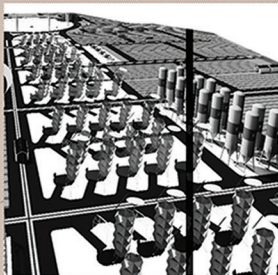

Temporary Regenerating City
The project is a social experiment, a opportunity as a territory of implementation due to the high levels of pollution that have been produced and deposited on this area for years. The idea is to create a community of specialists in order to be able to work with a high interest in recovering the soil surface to be used for farming. The community will have the condition of temporary construction and will provide homes, looking for ways to save as much surface as possible.



Location of the project (Detroit) Delay

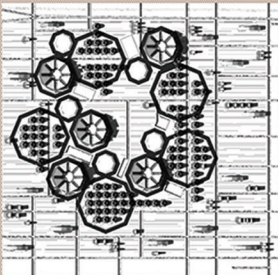

Railway Community capitolacion center
The project works as a homeless training center. Since Detroit became a city with an unusual amount of homeless, it has been developed a initiative that provides work for a exclusive housing complex but is composed of the necessary structure to be able to work and employed for the people. The objective is to create a complete social insertion through labor activities. The project is a general body can be generated and self-organized community, inserted in a city where economic crisis turned out into massive migration of its inhabitants.



Location of the project (Detroit) Burbank

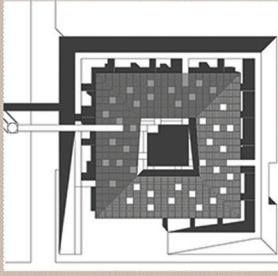

Detroit Familistere
This community aims to return to land and nature in order to solve the suffering and pollution that this abandoned territory has been treated. In order to create a new urban center, the project aims to be a community of specialists in order to be able to work with a high interest in recovering the soil surface to be used for farming. The community will have the condition of temporary construction and will provide homes, looking for ways to save as much surface as possible.



Location of the project (Detroit) Southwest

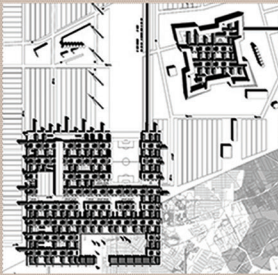

Detroit Relocated
General objective is an urban transformational intervention for the better, whose main purpose is the strengthening of human interactions following the principle of human scale design and the mixture of uses and functions within a territorial space which takes as typological strategy the "cluster" concept. The system seeks to create a community whose members interact around social nodes and regenerate them by merging them with the environment and creating an urban pattern that will be an extension of self-organized community, inserted in a city where economic crisis turned out into massive migration of its inhabitants.



Location of the project (Detroit) Delay

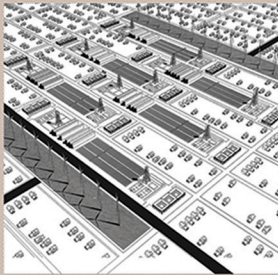

Westwood New Tenant farmers
Based in Frank Lloyd Wright's Broadacre City and starting from the pre-existing urban fabric of Westwood Park, with its grid of long blocks, the project aims to be a community of specialists in order to be able to work with a high interest in recovering the soil surface to be used for farming. The community will have the condition of temporary construction and will provide homes, looking for ways to save as much surface as possible.



Location of the project (Detroit) Westwood Park

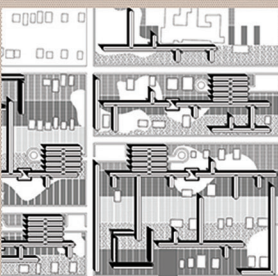

Experimental Dutch A. Frame Housing
The project is a social experiment, a opportunity as a territory of implementation due to the high levels of pollution that have been produced and deposited on this area for years. The idea is to create a community of specialists in order to be able to work with a high interest in recovering the soil surface to be used for farming. The community will have the condition of temporary construction and will provide homes, looking for ways to save as much surface as possible.



Location of the project (Detroit) Westwood Park

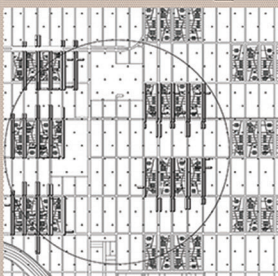

The Collective Urban form
The project is a social experiment, a opportunity as a territory of implementation due to the high levels of pollution that have been produced and deposited on this area for years. The idea is to create a community of specialists in order to be able to work with a high interest in recovering the soil surface to be used for farming. The community will have the condition of temporary construction and will provide homes, looking for ways to save as much surface as possible.



Location of the project (Detroit) Westwood Park